



UNIVERSITY OF NEBRASKA AT OMAHA DODGE CAMPUS PARKING MAP

402.554.2800 | unomaha.edu

UPDATED 09-08-20

Pull up to the booth at Lot E to park at the Barbara Weitz Community Engagement Center (CEC - Building #8) where the SBMLC lecture will be held.



BUILDING KEY

- 1 Allwine Hall (AH)
- 2 Arts & Sciences Hall (ASH)
- 3 Biomechanics Research Building (BRB)
- 4 Caniglia Field (CF)
- 5 Central Utilities Plant (CUP)
- 6 Child Care Center (CCC)
- 7 College of Public Affairs & Community Service (CPACS)
- 8 Barbara Weitz Community Engagement Center (Weitz CEC)
- 9 Criss Library (CL)
- 10 Durham Science Center (DSC)
- 11 East Parking Garage (EPG)
 - Lot T - Lower Level
 - Lot U - Middle Level
 - Lot V - Upper Level
- 12 Eppley Administration Building (EAB)
- 13 Health & Kinesiology Building (H&K)
- 14 Henningson Memorial Campanile (HMC) (clock tower)
- 15 Kayser Hall (KH)
- 16 Landscape Services (LS)
- 17 Maverick Village (MV)
- 18 Milo Bail Student Center (MBSC)
- 19 Pep Bowl (open space)
- 20 Resource Conservation & Recovery Area (RCRA)
- 21 Roskens Hall (RH)
- 22 Sapp Fieldhouse (SFH)
- 23 Sculpture & Ceramics Studio (SCS)
- 24 Strauss Performing Arts Center (SPAC)
- 25 Thompson Alumni Center (TAC)
- 26 University Village (UV)
- 27 Weber Fine Arts Building (WFAB)
- 28 6533 University Drive South (WC)
- 29 West Parking Garage (WPG)

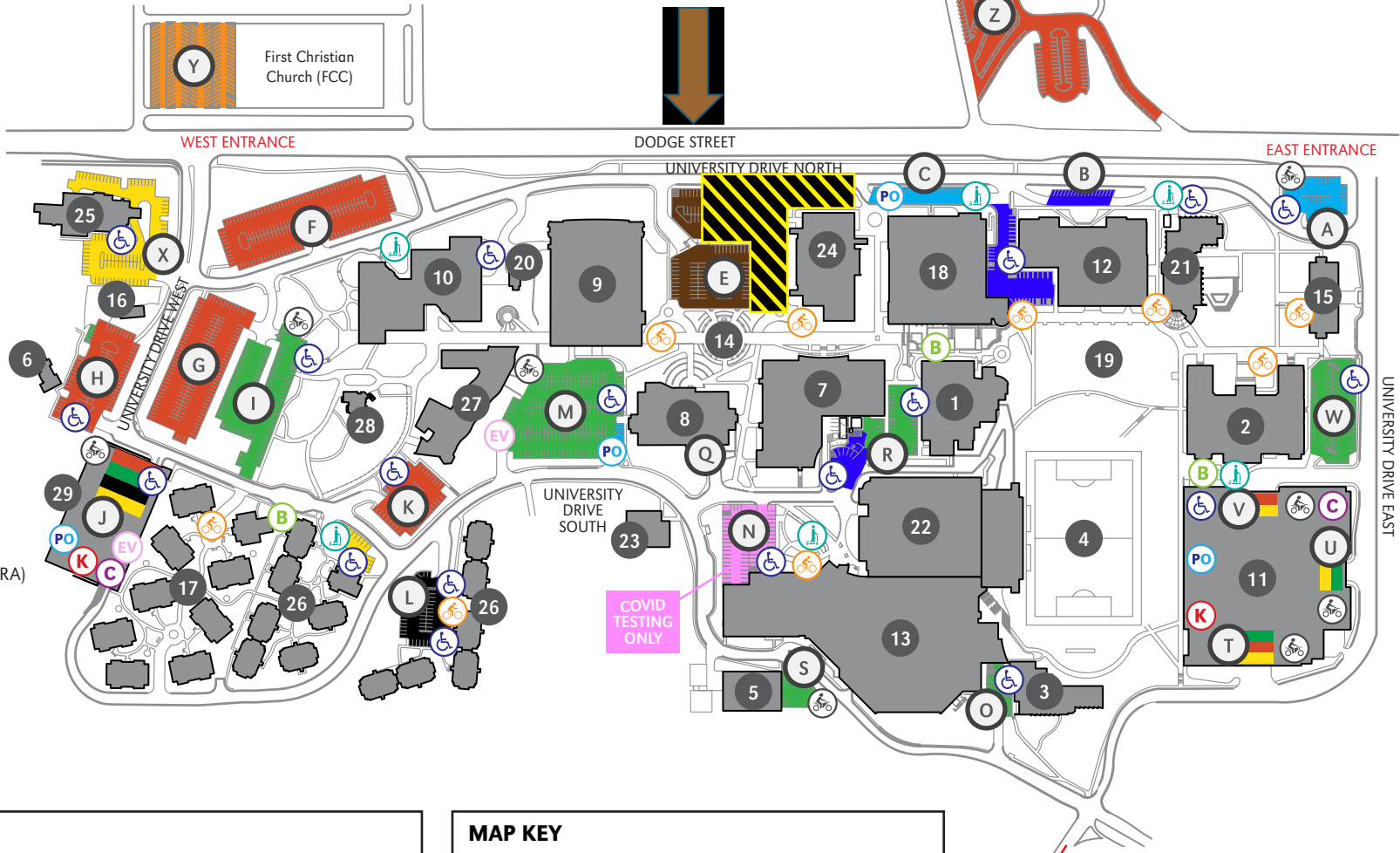

PARKING KEY

STUDENT	FACULTY
F/S/S SURFACE PERMITS	VISITOR (NO UNO)
RESERVED (NO F/S/S)	CEC VISITOR
EVENT PARKING	MV/UV RESIDENT
PARK OMAHA ONLY	CONSTRUCTION

PERMITS REQUIRED

Faculty/Staff/Stud.
Surface Lots:
 7 A.M. to 7 P.M. (M-TH)
 7 A.M. to 5 P.M. (F)

Garages:
 7 A.M. to 7 P.M. (M-TH)

MAP KEY

	Handicap Parking		Motorcycle Parking
	Park Omaha		Bicycle Racks
	Kiosks		Scooter Drop-off
	Carpool		B-Cycle Station
	EV Charging Station		

* Parking permit types are assigned to specific surface lots, garages, and/or garage levels. It is the responsibility of the permit holder to know which designated areas their permit is valid in.

TO SCOTT CAMPUS (0.75 MILES)
18 MIN WALK | 5 MIN BIKE



THIS IS A SMOKE- AND TOBACCO-FREE CAMPUS AS OF 8/22/16